

SHARPER IMAGE®



# PURIFY 5

## AIR PURIFIER

### OWNER'S GUIDE



MODEL  
PURIFY 5



# CONTENTS

Important Safety Instructions.....	4
Product Information.....	9
Getting Started.....	10
Control Panel.....	12
How to Use.....	13
True HEPA Filtration.....	14
Filter Replacement.....	15
Cleaning & Storage.....	17
Troubleshooting.....	18
Warranty.....	19

# READ AND SAVE THESE INSTRUCTIONS

## IMPORTANT SAFETY INSTRUCTIONS

This owner's guide and any additional inserts are considered part of the product. They contain important information about safety, use and disposal. Before using the product, please familiarize yourself with all operating and safety instructions. Please keep all documents for future reference and pass these documents on, together with the product, to any future owner. See [sihomecomfort.com](http://sihomecomfort.com) to view, download and print the most current version of these instructions.

**INTENDED USE:** This product is intended to purify the air in indoor living spaces only in the United States and Canada. This product is not intended for commercial or industrial use. The manufacturer assumes no responsibility for damage or injury due to the unauthorized use or product modification. Failure to follow these directions will void the product warranty. This product is intended to be used on the floor and not on an elevated surface such as a table or desktop.

### **WARNING: Risk to Children and Impaired Persons**

- Supervision is required during the installation, operation, cleaning and maintenance of this product by children age 12 years and younger and anyone with reduced physical, sensory or mental capabilities. Children should be supervised to ensure that they do not play with the appliance, its parts and packaging material.

### **INSTALLATION WARNING—To reduce risk of fire, electrical shock and injury to persons, observe the following:**

- Place this product away from curtains, draperies, tablecloths and

other fabrics, since they may be drawn into the product, damage the motor and/or cause a fire.

- No part of this product (the appliance, power cord, plug, packaging, etc.) should be placed near furnaces, fireplaces, stoves or other high temperature heat sources. Do not use this product in a window, on an uneven or unstable surface, or near water.
- The appliance, power supply, power cord and plug cannot come into contact with water. Do not use this product on wet surfaces. Do not use this product in a bathtub or shower or position product where it may fall into a bathtub, laundry, swimming pool or other water container. Do not use this product outdoors or expose it to weather or elements.
- Do not run cord under carpeting. Do not cover cord with throw rugs, runners, or similar coverings. Do not route under furniture or appliances. Arrange cord away from traffic area and where it will not be tripped over.
- The cord should not hang over edges of counters or be placed where it can be crimped or closed in doors. Place appliance near an easily accessible outlet so the product can be unplugged quickly during an emergency.

**SAFE USE WARNING—To reduce risk of fire, electrical shock and injury to persons, observe the following:**

- **WARNING:** To reduce likelihood of circuit overload, fire and electric shock, do not operate with a solid state speed device, such as a dimmer control switch.
- Do not operate unit if the unit has been dropped or damaged. Do not use this product if it has a damaged power cord or plug. To avoid risk of electrical shock, do not attempt to repair or replace parts. Only original replacement parts may be used. If the power cord is damaged, it must be replaced by the manufacturer, its service agent, or similarly qualified persons in order to avoid a hazard. Contact

(833.800.8669) or ([help@sihomecomfort.com](mailto:help@sihomecomfort.com)) for further instructions about replacement and repair.

- Risk of fire. Your appliance may be equipped with a detachable power supply or a cord/plug with a safety device such as a fuse. Use only the power cord and plug provided.
- Before plugging power cord into electrical outlet, be sure that all electrical information on the rating label, including voltage, is compatible with your outlet's power supply.
- Never use the cord as a handle or otherwise yank, strain or stretch the power cord.
- Do not sit or stand on product.
- Do not set anything on product or use as table or shelf.
- Do not use product without base properly installed.
- Do not use product without filter properly installed.
- While the product is plugged in, do not insert or allow foreign objects to enter any input or output opening as this may cause risk of electric shock or fire, or damage the product.
- A loose fit between wall outlet (receptacle) and plug may cause overheating and distortion of the plug. Discontinue use of the product in this outlet. Contact a qualified electrician to replace loose or worn outlets.
- This appliance has a polarized plug (one blade is wider than the other.) To reduce the risk of electric shock, this plug is intended to fit in a polarized outlet only one way. If the plug does not fit fully in the outlet, reverse the plug. If it still does not fit, contact a qualified electrician. Do not attempt to defeat this safety feature.
- Before moving, repositioning, servicing, cleaning and when not in use, use the product controls to turn off the power and then unplug. To disconnect from outlet, grasp and pull only the plug. Also, power off and unplug if the product will be left unattended for an extended period of time or during electrical storms.

**SERVICING WARNING—To reduce risk of fire, electrical shock and injury to persons, observe the following:**

- Clean your product regularly, only as is instructed in this manual. Prior to cleaning, turn off the power on your product and unplug. Do not use gasoline, thinners, solvents, ammonias or other chemicals for cleaning. Refer to the CLEANING instructions provided.
- Do not open appliance housing while product is plugged in. To avoid risk of shock, all service and/or repairs must be done by contacting (833.800.8669) or (help@sihomecomfort.com).

**FCC Compliance Statement**

This device complies with Part 15 of the FCC Rules. Operation is subject to the following two conditions: (1) This device may not cause harmful interference, and (2) this device must accept any interference received, including interference that may cause undesired operation.

**NOTE:** This equipment has been tested and found to comply with the limits for a Class B digital device, pursuant to part 15 of the FCC Rules. These limits are designed to provide reasonable protection against harmful interference in a residential installation. This equipment generates, uses and can radiate radio frequency energy and, if not installed and used in accordance with the instructions, may cause harmful interference to radio communications. However, there is no guarantee that interference will not occur in a particular installation. If this equipment does cause harmful interference to radio or television reception, which can be determined by turning the equipment off and on, the user is encouraged to try to correct the interference by one or more of the following measures:

- Reorient or relocate the receiving antenna.
- Increase the separation between the equipment and receiver.
- Connect the equipment into an outlet on a circuit different from that to which the receiver is connected.

- Contact Customer Service or dealer or an experienced radio/TV technician for help.

This Class B digital apparatus complies with Canadian ICES-003.

Changes or modifications not expressly approved by the party responsible for compliance could void the user's authority to operate the equipment.

**Supplier's FCC Declaration of Conformity**

Unique Identifier: Sharper Image Model PURIFY 5

Responsible Party: Vornado Air LLC

Mailing Address : 415 E. 13th St., Andover, KS 67002

Contact: [www.sihomecomfort.com](http://www.sihomecomfort.com)

**SAVE THESE INSTRUCTIONS**



# PRODUCT INFORMATION

1 CONTROL PANEL

2 OUTLET GRILL

3 FILTER FRAME

4 3-IN-1 FILTER  
CARTRIDGE

5 FILTER COMPARTMENT  
DOOR

6 FILTER COMPARTMENT  
DOOR PULL TAB

7 AIR INLET

8 POWER CORD (NOT  
SHOWN)

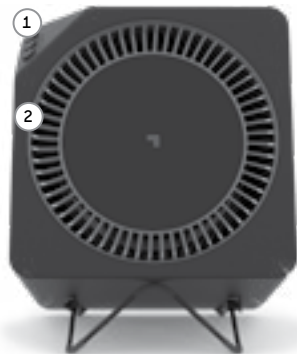

# GETTING STARTED

1. The product will require some assembly before use. The base ships in two separate pieces and will need to be assembled. Simply unscrew the pivot nuts on each base half (keeping the O-ring installed on the base), marry the two base halves together and reinstall the pivot nuts.

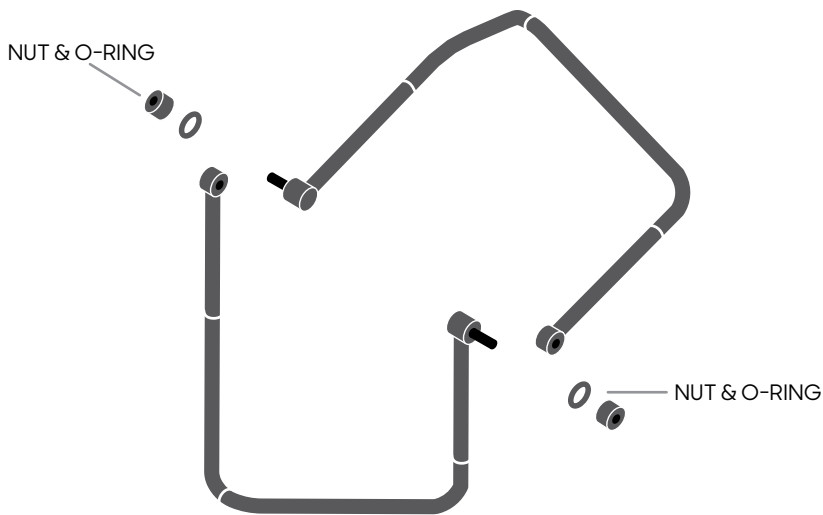

2. Once base is assembled and resting on floor, place the PURIFY 5 directly on the base.
3. To change the product orientation, simply flip the base over and rest the product on the base

**NOTE:** Do **NOT** place product directly on floor without base. Do **NOT** use product without base.



**NOTE:** In the upright position, ensure the rubber O-rings of the base are resting flat on the floor surface before use.



**NOTE:** In the forward facing position, ensure the rubber O-rings of the base are firmly positioned under the product before use.

# CONTROL PANEL

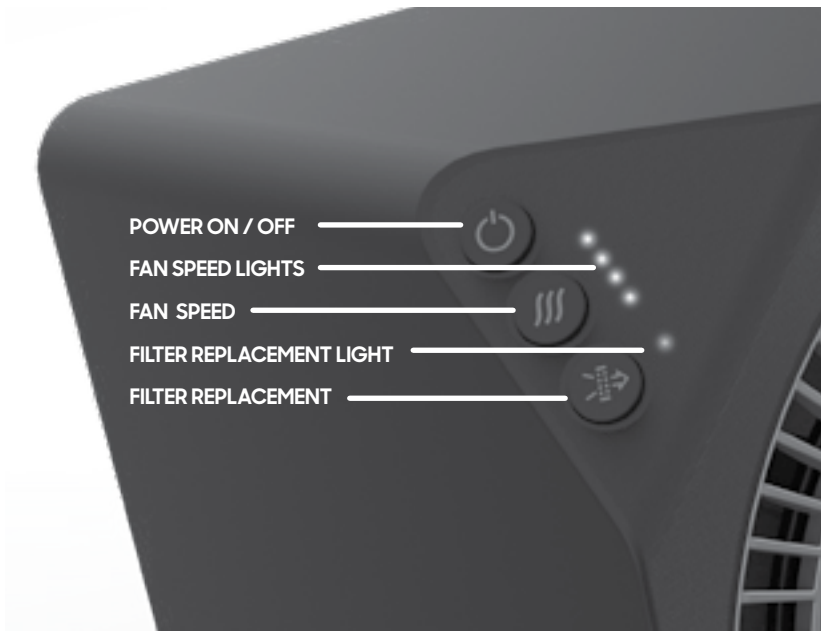

# HOW TO USE

1. Press  to power unit on and off.
2. Select desired speed by pressing **///**: Low, Medium, Medium-High, High. Speed is indicated by number of fan speed lights illuminated.

**NOTE:** Dust and allergens are most airborne when persons and pets are active in the room. For best results, set the unit on HIGH during these times for high demand cleaning and circulation. Set the unit to a lower setting for quieter operation when activity is reduced.

3. Filter Replacement – Your products is equipped with a Filter Replacement indicator light to show when it is recommended to change the filter cartridge. Please refer to FILTER REPLACEMENT for instructions. This feature is controlled by time of use. The light will illuminate after 4,500 hours of run time has accumulated.

**NOTE:** User environments will differ. The filter replacement time is based on average use situations. If you are using the air cleaner in a more demanding environment, you may need to change your filter more frequently. In less polluted environments the filter life may extend beyond the notification.

# TRUE HEPA FILTRATION

Without properly calibrated airflow, products with a True HEPA Filter will not achieve their full filtration potential. Gaps, poorly sealed filter housings, and excessive air velocity all reduce the effectiveness of the product. Independent testing laboratory verifies that the precise calibration of a Sharper Image Air Purifier allows it to perform at True HEPA standards.

## 3-IN-1 FILTRATION

Carbon filtration captures odors and prolongs HEPA filter life. The honeycomb design and use of carbon pellets enables the filter to adsorb more household odors and harmful gases than a traditional carbon filter. HEPA filtration captures 99.97% of particles 0.3 microns or larger, to effectively clean large volumes of air. The Pre-filter removes larger particles such as hair, pet dander, and mold spores.

Maintain the high efficiency of your Sharper Image Air Purifier by regularly replacing used filters with fresh new ones. Your Sharper Image Air Purifier will indicate with an illuminated filter replacement icon when it is time to change the filter cartridge. To purchase replacement filter cartridges, please email [help@sihomecomfort.com](mailto:help@sihomecomfort.com) or call 1-833-800-8669.



Part # **MD1-0045**

# FILTER REPLACEMENT

## **GENUINE SHARPER IMAGE FILTERS ARE RECOMMENDED**

Peak performance is only realized when genuine Sharper Image Carbon and HEPA filters are used. Others may claim to be compatible with Sharper Image units, but the Sharper Image Air Purifier is calibrated to achieve a 99.97% capture rate of particles 0.3 microns or larger, only when used with Sharper Image Filters.

## **HOW TO REPLACE YOUR FILTERS**

1. Turn off and unplug unit.
2. Turn over the unit and remove the Filter Frame by twisting the Filter Frame Support Tabs to the open position.
3. Remove and discard used Filters. Simply take hold of the Pre-Filter at any place along the perimeter and remove. To remove the Filter Cartridge, pull upward on side tabs until filter is removed.

**NOTE:** Clean any remaining dust or hair inside the unit by using a vacuum hose. Do Not use water or liquids to clean the unit.

4. Replace with genuine Sharper Image Filters. Place the Filter Cartridge in the unit and gently press around the perimeter to ensure placement. Carbon side of cartridge will go into the unit first so tabs on Hepa are facing up. Place Pre-Filter on top of Hepa.

**NOTE:** Take care to remove any plastic bag covering from your replacement filter.

5. Place Filter Frame on top of Pre-Filter and twist Filter Frame Support tabs into the locking position.
6. Turn unit right-side up.
7. To reset the Filter Replacement Indicator, press and hold  for approximately 3 seconds until Filter Replacement light has turned off.

**NOTE:** Do not operate the Air Purifier without a Sharper Image 3-in-1 Filter Cartridge.





# CLEANING & STORAGE

## HOW TO CLEAN

Because large volumes of air pass through your Air Purifier each day, it will need regular cleaning.

1. Turn unit off and unplug before cleaning.

**NOTE:** Do not use gasoline, thinners, solvents or other chemicals for cleaning.

2. Wipe down with a soft, damp cloth.
3. Dust or vacuum the top air outlet. It is recommended to clean the interior when the Filters are changed.

The motor is permanently lubricated so it needs no service. No other serviceable parts, other than Filters, are contained within the unit.

## STORAGE

Follow the steps listed below when you are ready to store your unit.

1. Unplug power cord and bundle loosely.
2. Cover, or place back in retail carton if available. This will prevent unit from accumulating dust over time.
3. Store unit in cool and dry location.

# TROUBLESHOOTING

## PROBLEM

## POSSIBLE CAUSE AND SOLUTION

<p>The unit fails to power on.</p>	<p>Unit is not plugged in. Plug power cord into electrical outlet.</p> <p>Household circuit breaker/ground fault circuit interrupter has tripped or blown fuse. Reset circuit breaker/ground fault circuit interrupter, or replace fuse. For assistance, contact licensed electrician.</p> <p>Unit is damaged or in need of repair. Cease usage and unplug. Contact Consumer Service for assistance.</p>
<p>Airflow is weak or slow.</p>	<p>Unit set to a low speed setting. Adjust to a higher speed setting.</p> <p>Debris build-up on filter. Check and replace Filters.</p> <p>Airflow is blocked. Remove obstruction.</p> <p>Replacement filter is wrapped in polybag. Check filters to ensure all plastic packaging is removed before use.</p>

# 2

YEAR

SATISFACTION  
GUARANTEE

# WARRANTY

If you're not satisfied with this product, let us know.

Vornado Air, LLC warrants to the original consumer or purchaser this Sharper Image® Air Purifier ("Product") is free from defects in material or workmanship for a period of two (2) years from the date of purchase. If any such defect is discovered within the warranty period, Sharper Image, at its discretion, will repair or replace the Product at no cost.

For warranty or repair service: Call 833-800-8669 or email [help@sihomecomfort.com](mailto:help@sihomecomfort.com) to obtain a Return Authorization ("RA") form. Please have or include your Product's model number and serial number, as well as your name, address, city, state, zip code and phone number when contacting Vornado for warranty service.

After receiving the RA form, ship your Product to: Vornado Air LLC Attn: Warranty & Repair 415 East 13th Street Andover, KS 67002. For your convenience, please have your model number and serial number when contacting Vornado with service inquiries. To assure proper handling, packages must be clearly marked with the RA number. Packages not clearly marked with the RA number may be refused at the receiving dock. Please allow 1-2 weeks for repair and return of your Product after the Product is received.

Repairs not covered by the warranty or outside the warranty period will require a fee to cover the cost of materials, labor, handling and shipping.

This warranty does not apply to defects resulting from abuse of the Product, modification, alteration, mishandling, improper maintenance, commercial use or repair or service of the Product by anyone other than Vornado; damages which occur in shipment or are attributed to acts of God. Improper product use, which includes using

an external device that alters or converts the voltage or frequency of electricity, or shipping a Vornado product to a country not intended for use will void all warranties. Any unauthorized product modification, repair by unauthorized repair center, or use of non-approved replacement parts is not recommended and any consequences will not be covered by support services or product warranties. The product warranty will be honored only on models that are being used in the country intended. REPAIR OR REPLACEMENT AS PROVIDED UNDER THIS WARRANTY IS THE EXCLUSIVE REMEDY OF THE CONSUMER. VORNADO SHALL NOT BE LIABLE FOR ANY INCIDENTAL OR CONSEQUENTIAL DAMAGES FOR BREACH OF ANY EXPRESS OR IMPLIED WARRANTY ON THIS PRODUCT. EXCEPT TO THE EXTENT PROHIBITED BY APPLICABLE LAW, ANY IMPLIED WARRANTY OF MERCHANTABILITY OR FITNESS FOR A PARTICULAR PURPOSE ON THIS PRODUCT IS LIMITED IN DURATION TO THE DURATION OF THIS WARRANTY. Some states do not allow the exclusion or limitation of incidental or consequential damages, or allow limitations on how long an implied warranty lasts, so the above limitations or exclusions may not apply to you. This warranty gives you specific legal rights, and you may have other rights that vary from state to state. The manufacturer assumes no responsibility for damage caused by failure to follow these instructions or improper product use. Any such actions will invalidate the product warranty.

All company names and product names are trademarks of their respective owners. © All rights reserved. All technical information, data, and instructions for the installation, connection, and operation contained in these instructions for use correspond to the latest available information at time of printing. The contents of this manual may differ slightly from the actual product. Observe any additional supplements.

©2020 Vornado Air LLC, Andover, Kansas 67002 USA.  
Specifications subject to change without notice.  
Sharper Image® name and logo are registered trademarks.  
Manufactured, marketed and distributed under license by Vornado Air LLC, Andover, Kansas 67002.  
Manufactured in China.  
U.S. Patents Pending.

Sharper Image® Distributed under license by Vornado Air LLC, Andover, Kansas 67002.

**S H A R P E R I M A G E<sup>®</sup>**